

SCL17-30

Precious metal commutation

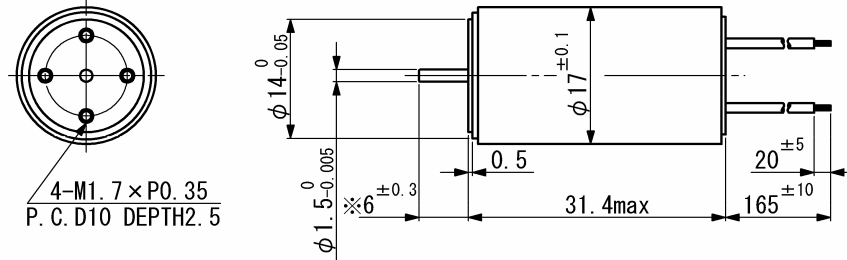

Weight 42 g
Dimension in mm

Note) Dimension marked ※ is measured with shaft pushed against motor.

For combination with gearheads: SSG15, SPG16

| Ordering number | SCL17 | | | | | |
|-----------------------------|-------|-------|-------|-------|-------|-----------------------|
| | -3003 | -3005 | -3006 | -3011 | -3017 | -3026 |
| 1 Nominal voltage | 6 | 8 | 9 | 12 | 15 | 18 V |
| 2 Terminal resistance | 2.7 | 4.6 | 6.1 | 11 | 17 | 26 Ω |
| 3 Output power | 3.4 | 3.4 | 3.3 | 3.3 | 3.4 | 3.0 W |
| 4 Efficiency | 87 | 87 | 87 | 87 | 87 | 86 % |
| 5 No-load speed | 8830 | 9000 | 9060 | 9000 | 9250 | 8940 rpm |
| 6 No-load current | 10 | 8 | 7 | 5 | 4 | 4 mA |
| 7 Stall torque | 14.6 | 14.5 | 13.8 | 13.8 | 13.9 | 13.0 mNm |
| 8 Friction torque | 0.068 | 0.068 | 0.068 | 0.068 | 0.068 | 0.068 mNm |
| 9 Back-EMF constant | 0.68 | 0.89 | 0.99 | 1.3 | 1.6 | 2.0 mV/rpm |
| 10 Torque constant | 6.5 | 8.4 | 9.4 | 12.7 | 15.4 | 19.1 mNm/A |
| 11 Slope of N-T curve | 610 | 620 | 660 | 650 | 670 | 690 rpm/mNm |
| 12 Coil inductance | 0.029 | 0.050 | 0.062 | 0.11 | 0.17 | 0.26 mH |
| 13 Mechanical time constant | 5 | 5 | 5 | 5 | 5 | 5 ms |
| 14 Rotor inertia | 0.76 | 0.74 | 0.70 | 0.70 | 0.69 | 0.68 gcm ² |
| Continuous operation | | | | | | |
| 15 Max. torque | 4.8 | 4.8 | 4.7 | 4.7 | 4.6 | 4.5 mNm |

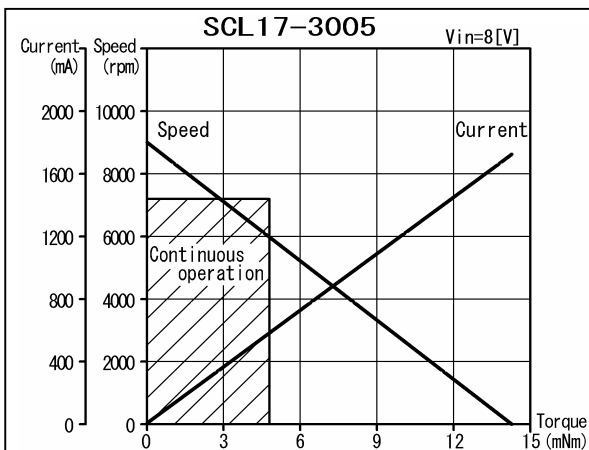

General specifications

| | | |
|----------------------------------|---|-----|
| 16 Operating temperature | -20...+60 | °C |
| 17 Max. coil temperature | +80 | °C |
| 18 Thermal resistances | R _{th1} = 4, R _{th2} = 25 | K/W |
| 19 Bearings type | Sintered sleeves | |
| 20 Max. shaft radial load | 1.2 (5 mm) | N |
| 21 Max. shaft axial load | 0.2 | N |
| 22 Max. axial load at standstill | 9.8 | N |
| 23 Shaft radial play | 0.05 | mm |
| 24 Shaft axial play | 0.03...0.2 | mm |

Options:

Lead wires length, shaft length, special coils, commutator with capacitors.

V01

Namiki Precision of Singapore Pte Ltd.
TEL: +65-6227-2862 FAX: +65-6227-3327
URL: www.namikisingapore.com.sg/
E-mail: namikisales@nps.com.sg

Specifications subject to change without notice